

The logo for SFLUX AWARDS is centered within a white square with a dark grey border. The word 'SFLUX' is in a large, bold, sans-serif font, with 'SF' in yellow and 'LUX' in black. Below it, the word 'AWARDS' is in a similar bold, sans-serif font, entirely in yellow.

SFLUX
AWARDS

LUMEN EXCELLENCE

ILLUMINATING ENGINEERING SOCIETY 2018

WELCOME TO THE SF·LUX AWARDS

APRIL NINETEENTH · TWO THOUSAND EIGHTEEN

ILLUMINATING ENGINEERING SOCIETY · SAN FRANCISCO SECTION

5:30 COCKTAILS

7:00 DINNER

8:30 PRESENTATION

9:15 AFTER-PARTY

THE GREEN ROOM

SAN FRANCISCO WAR MEMORIAL AND PERFORMING ARTS CENTER

SAN FRANCISCO · CALIFORNIA

HOSTED BY

MJ PAUL · EMCEE · LUMIUM LIGHTING
CLIFTON LEMON · PRESIDENT · IES-SF

EVENT ORGANIZERS

MJ PAUL, CHAIRMAN · LUMIUM LIGHTING
JOE VUKOV · HIRAM BANKS LIGHTING DESIGN
LINDA SANFORD · PG&E
ROCHELLE KIMBALL · IES-SF

CONSULTANTS

BONGZ NGUYEN · VIDEO EDITING
GREG ESTEP · MARKETING · LIGHTING SYSTEMS
JACQUELINE DEVINS · POPPY CART FLORAL
MAUREEN KELLY · KNIGHT'S CATERING
NICK ADAMS · DRONE FOOTAGE · PARALLAX
SAMANTHA ALLEN · SF WAR MEMORIAL

DISTINGUISHED JURY PANEL

JEREMY STEINMEIER · GENSLER
KRISTIN PECK · PRITCHARD PECK LIGHTING
LINDA SANFORD · PG&E
SARA MCBARNETTE · AUERBACH GLASOW

(PANELISTS ABSTAIN FROM JUDGING ANY PROJECT
THAT IS A CONFLICT OF INTEREST.)

SUPPORTING BAY AREA REPRESENTATIVES

AMBER HOHMAN · ARCHETYPE
CELINE MARCIPAN · SIXTEEN5HUNDRED
LINDSAY WICKS · ALR
MELINDA LAVALLE · CAL LIGHTING
NAZZI NAZERI · LIGHTING SYSTEMS

PYRAMID PLATINUM LEVEL SUPPORTERS
PREMIUM FULL TABLE SPONSORS

ARCHETYPE

EATON

FINELITE[®]



Hubbell Lighting, Inc.



Lumium

lighting at its **e**lement

GOLDEN GATE GOLD LEVEL SUPPORTERS
FULL TABLE SPONSORS

a·light

B-K LIGHTING  **TEKA**
ILLUMINATION

ECOSENSE®

 luminii

 optic arts

PHILIPS

tivoli

USAI
Lighting

SUTRO SILVER LEVEL SUPPORTERS
HALF TABLE SPONSORS

ALR
BORDEN
LIGHTING

CAL
LIGHTING

KETRA

lumenpulse
GROUP

 **PINNACLE**
ARCHITECTURAL LIGHTING®

TARGETTI

tempo®

CATEGORIES

INTERIOR LIGHTING DESIGN

SPONSORED BY EDWIN GUTH

IN 1902, EDWIN F. GUTH FOUNDED THE ST. LOUIS BRASS COMPANY AND LATER RENAMED IT THE EDWIN F. GUTH COMPANY. MR. GUTH'S PROFOUND CREATIVITY, ENTREPRENEURIALISM, AND FOCUS TO IMPROVE INTERIOR LIGHTING ARE PARTIALLY REPRESENTED THROUGH 147 PATENTS AWARDED TO HIM PRIOR TO HIS PASSING IN 1962. THIS AWARD RECOGNIZES EXCEPTIONAL INTERIOR LIGHTING PROJECTS THAT BALANCE THE FUNCTIONAL ILLUMINATION OF SPACE WITH THE ARTISTIC APPLICATION OF LIGHT TO ENHANCE THE OCCUPANTS' EXPERIENCE.

LIGHTING CONTROL INNOVATION

SPONSORED BY LIGHTING CONTROLS ASSN.

ADVANCED LIGHTING CONTROL SOLUTIONS CAN PROVIDE SIGNIFICANT ENERGY SAVINGS, FLEXIBILITY, AND OTHER BENEFITS IN BUILDINGS. THIS PRESTIGIOUS AWARD RECOGNIZES EXEMPLARY LIGHTING PROJECTS THAT DEMONSTRATE THE EFFECTIVE USE OF LIGHTING CONTROLS IN NONRESIDENTIAL APPLICATIONS.

OUTDOOR LIGHTING DESIGN

SPONSORED BY EATON

THE OUTDOOR LIGHTING DESIGN AWARD RECOGNIZES EXCELLENCE IN LIGHTING DESIGN AND APPLICATION IN ALL ASPECTS OF EXTERIOR LIGHTING. THE PROGRAM CELEBRATES ACHIEVEMENTS IN AESTHETICS, APPLIED TECHNICAL ACUMEN, CREATIVE SOLUTIONS TO DEMANDING SITE CONDITIONS, AND ADVANCEMENTS TO THE INDUSTRY IN OUTDOOR LIGHTING APPLICATIONS. THE GOAL OF THE PROGRAM IS TO FURTHER THE UNDERSTANDING, KNOWLEDGE, AND FUNCTION OF OUTDOOR LIGHTING AS A CRITICAL ASPECT OF THE BUILT ENVIRONMENT.

ENERGY & ENVIRONMENTAL LIGHTING DESIGN

SPONSORED BY OSRAM SYLVANIA

THE ENERGY AND ENVIRONMENTAL LIGHTING DESIGN AWARD RECOGNIZES QUALITY LIGHTING INSTALLATIONS IN COMMERCIAL AND INDUSTRIAL BUILDINGS THAT INCORPORATE ADVANCED ENERGY-SAVING STRATEGIES AND ENVIRONMENTALLY RESPONSIBLE SOLUTIONS INTO THE OVERALL DESIGN.

PROGRAM

“NEW AND ADAPTIVE WORKSPACES”

VIDEO ONE

PRESENTED BY:

CLIFTON LEMON

PRESIDENT • IES-SF

CLIFTON LEMON ASSOCIATES

“LIGHTING FOR LEISURE”

VIDEO TWO

PRESENTED BY:

KRISTIN PECK

PRINCIPAL

PRITCHARD PECK LIGHTING

“HARVESTING AND CONSERVING ENERGY”

VIDEO THREE

PRESENTED BY:

LINDA SANFORD

SENIOR LIGHTING PROGRAM COORDINATOR

PG&E

“IMMERSIVE ILLUMINATION”

VIDEO FOUR

PRESENTED BY:

MAX PIERSON

PRINCIPAL

MINUSCULE LIGHTING DESIGN

INTERIOR LIGHTING DESIGN CATEGORY

2018 SF-LUX AWARD ENTRANTS



ADAPTIVE REUSE – LANDSCAPE ARCHITECTS OFFICE
SAN FRANCISCO, CALIFORNIA

SHERRY WELLER

WELLER DESIGN ARCHITECTURAL LIGHTING

PHOTOS: KELLY DUGGAN, SHERRY WELLER



NEW WINGS AT ASIAN CIVILIZATIONS MUSEUM
SINGAPORE

**JACK LIM, CHERRY WANG, ROBERT TSU, DAN FOREMAN, YI-HUI TEH,
KEY ANDERSON, SUDHIR BOMMU, NIGEL GREENHILL, AND SAU KEI LI**
ARUP / GREENHILL ARCHITECTS

YING YI PHOTOGRAPHY



BMW LOUNGE
SAN JOSE, CALIFORNIA

THOMAS SKRADSKI, MEENAM LEE-LABRIE, AND ZHENG ZHONG
LUMENWORKS INC.

PHOTOS: THOMAS SKRADSKI, MEENAM LEE-LABRIE



JUMP - JACK'S URBAN MEETING PLACE
BOISE, IDAHO

**KELLY ROBERSON, NORM SCHWAB, ADAM RECHNER, MIKE MAIO,
AND PAUL MEASOM**
LIGHTSWITCH

MICHAEL MCCULLOUGH PHOTOGRAPHY

INTERIOR LIGHTING DESIGN CATEGORY

2018 SF-LUX AWARD ENTRANTS



LUCKY DRAGON HOTEL AND CASINO
LAS VEGAS, NEVADA

**JANELLE DROUET, JOHN CUMISKEY, LEE CAGLEY,
MATT BURNS, AND ED VANCE**
LIGHTSWITCH ARCHITECTURAL / LEE CAGLEY DESIGN / ED VANCE & ASSOC.
PHOTOS: TERRY MAHANNA, MPHOTO7

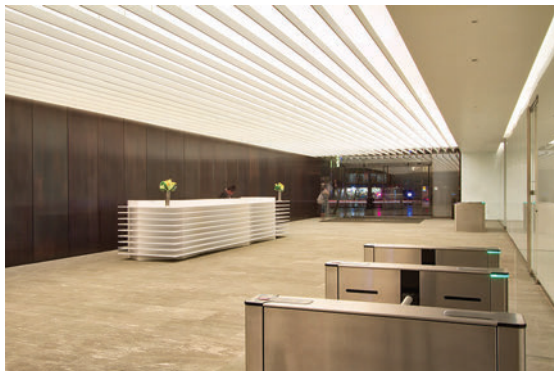

MARKET STREET LOBBY
SAN FRANCISCO, CALIFORNIA

CLAUDIO RAMOS AND SAM DAVEY
ELECTROLIGHT
PHOTOS: BRIAN ASHBY MEDIA

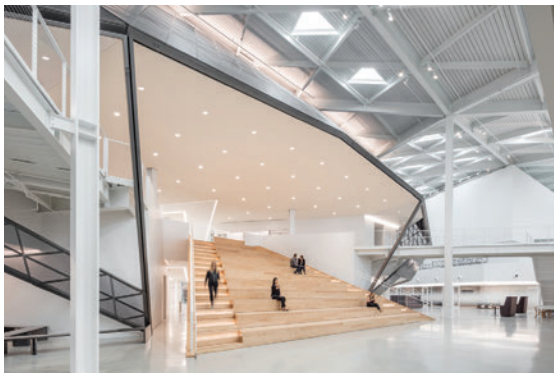

NVIDIA CAMPUS

SANTA CLARA, CALIFORNIA

**HAYDEN MCKAY, ALESSIA POPE, JOHN KEYES, ANGELA MCDONALD,
VASUDHA RATHI, AND BRIAN FRANCO**

HLB LIGHTING DESIGN

PHOTOS: CONNIE ZHOU AND JASON O'REAR



SAN DIEGO CENTRAL COURTHOUSE

SAN DIEGO, CALIFORNIA

ANGELA MCDONALD, LILIAN FU, AND VASUDHA RATHI

HLB LIGHTING DESIGN

BRUCE DAMONTE PHOTOGRAPHY

INTERIOR LIGHTING DESIGN CATEGORY

2018 SF-LUX AWARD ENTRANTS



SINGLE THREAD RESTAURANT
HEALDSBURG, CALIFORNIA

JANELLE DROUET, JOHN CUMISKEY, AND ANDREW LIEBERMAN
LIGHTSWITCH ARCHITECTURAL / AVROKO

GARRETT ROWLAND PHOTOGRAPHY



SUFFOLK SAN FRANCISCO HEADQUARTERS
SAN FRANCISCO, CALIFORNIA

CLAUDIO RAMOS
ELECTROLIGHT

VITTORIA ZUPICICH PHOTOGRAPHY

ENERGY & ENVIRONMENTAL DESIGN CATEGORY
2018 SF-LUX AWARD ENTRANT



WALLIS ANNENBERG PETSPACE
PLAYA VISTA, CALIFORNIA

HIRAM BANKS, MATTHEW LANDL, AND TOBIAS HOLDEN
HIRAM BANKS LIGHTING DESIGN

PHOTOS: ELON SCHOENHOLZ



ASID HEADQUARTERS
WASHINGTON DC

JAMES BENYA AND DEBORAH BURNETT
BENYA BURNETT CONSULTANCY

PHOTOS: ERIC LAIGNEL AND PERKINS+ WILL

OUTDOOR LIGHTING DESIGN CATEGORY

2018 SF-LUX AWARD ENTRANTS



NEW WINGS AT ASIAN CIVILIZATIONS MUSEUM
SINGAPORE

**JACK LIM, CHERRY WANG, ROBERT TSU, DAN FOREMAN, YI-HUI TEH,
KEY ANDERSON, SUDHIR BOMMU, NIGEL GREENHILL, AND SAU KEI LI**
ARUP / GREENHILL ARCHITECTS

YING YI PHOTOGRAPHY



LUCKY DRAGON HOTEL AND CASINO
LAS VEGAS, NEVADA

**JANELLE DROUET, JOHN CUMISKEY, LEE CAGLEY,
MATT BURNS, AND ED VANCE**
LIGHTSWITCH ARCHITECTURAL / LEE CAGLEY DESIGN / ED VANCE & ASSOC.

PHOTOS: TERRY MAHANNA, MPHOTO7

LIGHTING CONTROL INNOVATION CATEGORY
2018 SF-LUX AWARD ENTRANT



UNIVERSITY OF CA BERKELEY – MOFFITT LIBRARY TERRACE
BERKELEY, CALIFORNIA

VASUDHA RATHI AND BRANDON THRASHER
HLB LIGHTING DESIGN

JASPER SANIDAD PHOTOGRAPHY



FORWARD MEDICAL SF
SAN FRANCISCO, CALIFORNIA

**HIRAM BANKS, MATTHEW LANDL, TOBIAS HOLDEN,
AND TAN MEKATHIKOM**
HIRAM BANKS LIGHTING DESIGN

PHOTOS: JEREMY BITTERMANN

THE ILLUMINATING ENGINEERING SOCIETY (IES) SEEKS TO IMPROVE THE LIGHTED ENVIRONMENT BY BRINGING TOGETHER THOSE WITH LIGHTING KNOWLEDGE AND BY TRANSLATING THAT KNOWLEDGE INTO ACTIONS THAT BENEFIT THE PUBLIC.

THE IES HAS BUILT UPON A CENTURY OF EXCELLENCE TO CREATE THE PREMIER LIGHTING COMMUNITY DEDICATED TO PROMOTING THE ART AND SCIENCE OF QUALITY LIGHTING TO ITS MEMBERS, ALLIED PROFESSIONAL ORGANIZATIONS, AND THE PUBLIC.

THE SAN FRANCISCO SECTION OF THE ILLUMINATING ENGINEERING SOCIETY HOLDS ANNUALLY THE SF-LUX AWARDS AND BANQUET. WHILE SELECTED PROJECTS RECEIVE LOCAL IES SF SECTION SF-LUX AWARD RECOGNITION, ALL ENTRIES ARE SUBMITTED FOR ON-LINE JUDGING IN THE NATIONAL IES ILLUMINATION AWARDS.



IES SAN FRANCISCO SECTION
APRIL 2018

